



#300 & #302 CHLORINE/BROMINE FEEDERS

Features:

- No special venting required.
- Completely enclosed-no escaping gases.
- Positive external no-clog control valve.
- Feeder is designed to automatically lower the water level so tablets are not soaking during off period of pump. This allows more efficient use of tablets.

- No equipment damage. Feeds sanitizer directly to pool or spa.
- All parts replaceable.
- To prevent over feeding during use, completely close the control valve and the built in check valve will prevent chemical from being fed into pool or spa.

YOUR LIFEGARD® FEEDER IS THE MOST EFFICIENT AND TROUBLE-FREE AUTOMATIC FEEDER YOU CAN BUY, BUT IT CAN ALSO BE DANGEROUS TO YOU AND YOUR EQUIPMENT. PLEASE FOLLOW INSTRUCTIONS EXACTLY AND HEED ALL CAUTIONS. YOUR SAFETY AND THE PROTECTION OF YOUR EQUIPMENT IS OUR FIRST CONCERN.

It is important to read all information BEFORE proceeding with the installation. The information will guide you in installing your feeder properly and to avoid problems due to improper installation.

IF YOUR POOL OR SPA HAS COPPER PLUMBING . . . STOP!!

Never install the feeder into copper plumbing as pipe damage will occur. (See Equipment Safety CAUTION sheet enclosed). **NOTE:** If heaters are used, a Fireman's Switch or equivalent must be installed to prevent possible damage and improper operation of Check Valve and other equipment subject to heat damage.

WHERE TO INSTALL YOUR FEEDER

Series #300 and #302 are designed for EXISTING pools or spas or new pools or spas where conditions are such to make permanent installation into the return line impractical. The outlet line must be installed after the heater. If your pool does not have a heater, then it must be installed after the filter. (see Fig. A & B)

DAMAGE TO YOUR HEATER COULD RESULT IF HIGHLY CHLORINATED WATER FLOWS THROUGH IT.

If your pool has a heater, install the line to the feeder between the filter and heater. If your pool does not have a heater, install the inlet line between the pump and the filter. Refer to installation drawings A & B for your particular condition. Choose a site where feeder can be installed in a vertical position. Always install as far from any metal equipment as practical since fumes, etc. can corrode them. If optional corrosion resistant check valve is required, refer to installation instructions before next step.

INSTALLATION INSTRUCTIONS

Position feeder close to filter and cut tubing to desired lengths. Be careful to cut ends straight.

ATTACH INLET LINE TO FEEDER

Screw control valve into side of feeder. Use teflon tape to seal threads. Push compression nut over tubing and then push tubing onto tapered end of control valve. Tighten nut firmly by hand.

ATTACH OUTLET LINE TO FEEDER

Screw Combination check valve elbow into bottom of feeder. Refer to drawing on other side. Use teflon tape to seal threads. **CAUTION,** do not overtighten. Damage to threads or check valve could occur. Push compression nut over tubing end. Then push tubing onto tapered end of elbow. Tighten nut firmly by hand.

INSTALL INLET LINE IN PLUMBING

(Line to side of feeder). Turn off pump and timer switches. Drill $\frac{3}{8}$ " hole in plumbing, remove burrs and install saddle clamp assembly. See drawing on other side. Attach inlet line by first pushing compression nut over tube end. Then push tube onto tapered end of tube fitting. Tighten nut firmly by hand.

INSTALL OUTLET LINE IN PLUMBING

(Line from feeder.) Drill $\frac{3}{8}$ " hole in plumbing (AFTER the heater. If no heater, drill after filter.) and remove burrs. See drawing on other side. Install saddle clamp assembly. Attach outlet line by first pushing compression nut over tube end. Then push onto tapered end of tube fitting. Tighten nut firmly by hand. Installation is now complete.

OPERATING INSTRUCTIONS

Before start up of feeder, your pool should be properly conditioned and the residual should be 1.0 to 1.5 ppm, (Bromine 2.0-4.0 ppm). The water in a newly-filled pool should be properly conditioned to insure maximum effectiveness of

the feeder. Consult your local dealer for water conditioning information for your area.

1. Remove cap of feeder and fill with proper size tablets.

Series 300 uses 1" or 3" dia. tablets

Series 302 uses 1" dia. tablets in Spa Chamber.

2. Making sure O-Ring is clean, lubricated with Lifeguard Silicone and is in place, replace cap. Hand tighten only.

3. Turn on pump and timer switches.

4. Adjust control valve according to your pool/spa size. Use a test kit. It is recommended that the chemical residual be checked daily for the first 5 days. Remember . . . hot days, higher water temperature or increased pool/spa activity will cause your pool/spa to use more sanitizer. When possible, increase the feed rate a day or two in advance. Because the sanitizer demand in your pool/spa varies and is dependent on many factors (sunlight, bather load, water temperature, etc) your valve setting may have to be changed from time to time to adjust to these conditions. For example, the winter setting may be #2 while the summer setting is #3. Check the residual daily to find the ideal setting. Note: Higher numbers dispense more chemical. Small gradual changes are imperative for control.

HOW TO RECHARGE FEEDER

1. Turn control valve to the closed position. **SHUT OFF PUMP.**

2. Wait one minute. This will allow water and fumes to drain from feeder.

3. Leave control valve closed and turn on pump. The check valve will prevent water from entering the feeder.

4. Remove cap and fill with proper size tablets or sticks. (See Operating Instructions #1)

5. Making sure O-Ring is clean, lubricated with Lifeguard Silicone and is in place, replace cap. Hand tighten only.

6. Open control valve to original setting. Inspect inlet and outlet line each time feeder is recharged. Replace lines yearly if necessary.

BELOW WATER LEVEL INSTALLATION

Feeder should be installed above water level whenever practical. If installed below water level, a drain valve must be installed to prevent spillage and dangerous splash back of high chlorinated water during recharging. Drill and tap a $\frac{1}{4}$ " MPT hole at the same level the control valve is located. Make sure there is no water or tablets inside the feeder before drilling. Install optional drain valve, Part R172060, or suitable chemical resistant drain valve.

BELOW WATER LEVEL RECHARGING INSTRUCTIONS

1. Shut off pump and timer switches.

2. Shut off control valve.

3. Place a clean container under drain and open drain valve.

4. Exercise extreme caution when opening or servicing feeder. Do not inhale fumes. Wear protective gear. Remove cap. Water will now drain from feeder. Empty container back into pool or spa.

5. Close drain valve. fill with proper size tablets or sticks.

6. Making sure O-Ring is clean, lubricated with Lifeguard Silicone and in place, replace cap.

7. Turn on pump and timer switches.

8. Reset control valve to original setting. Inspect inlet and outlet line each time feeder is recharged. Replace lines yearly if necessary.

⚠ DANGER

READ CAREFULLY

This feeder is designed to use only Trichloro-s-triazinetriene OR Bromine tablets-slow dissolving type **UNDER NO CIRCUMSTANCES** mix Trichlor OR Bromine with Calcium Hypochlorite, with other forms of concentrated chlorine or with other chemicals **FIRE AND EXPLOSION MAY RESULT. NEVER** use oils or grease to lubricate O-ring. Oil in contact with Trichlor OR Bromine may result in fire. Lubricate O-ring with Lifeguard Silicone O-ring Lubricant only, available at your dealer. Caution should be used when removing feeder cap. **Do not inhale fumes.** If shock treatments or Algaecides containing chemicals other than sanitizer tablets in feeder must be used, **turn off Feeder OR remove tablets until the shock or Algae treatment is complete and all granuals have dissolved.** Failure to do so may result in granules mixing in feeder causing **FIRE AND/OR EXPLOSION.** The shock or algae treatment dissolved in water is safe with tablets.



CAUTION
Do not install feeder into copper plumbing. Pipe damage could occur.
Never install feeder before heater.
Heater damage could occur.

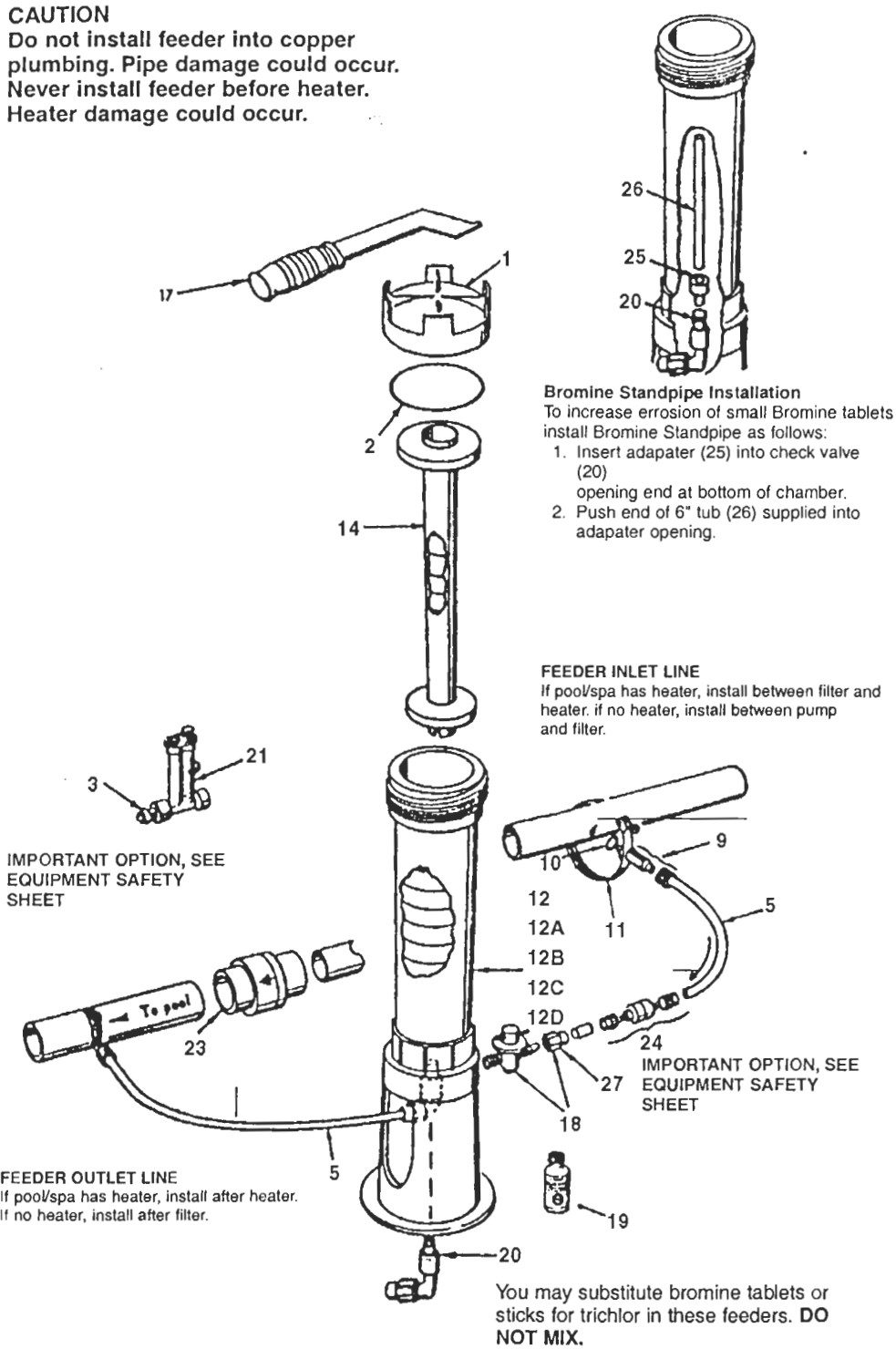

**#300-302 CHLORINE / BROMINE FEEDER
PARTS BREAK DOWN DRAWING**

Item	Qty.	Part No.	Description
1	1	R172008	3" Threaded cap
2	1	R172009	O-Ring cap
*3	1	R172020	Check valve
*4	1	R172022	Chlorine control valve
5	8'	R172023	3/8" OD x 1/4" ID tubing
*6	1	R172029	Male tube fitting 1/4" NPT
8	1	R172031	Female tube fitting 1/4" NPT
9	2	R170032	Tube fitting with nut
10	2	R172033	Gasket
11	2	R172034	Saddle clamp
12	1	R172035	Body assy. w/stand #300
12A	1	R172075	Body assy. w/stand #300-19
12B	1	R172076	Body assy. w/stand #300-29
12C	1	R172035A	Body assy. w/stand #302
*13	1	R172038	90° tube fitting-female 1/4" NPT
14	1	R172037	Spa chamber #302 only
17	1	R172052	Cap wrench (optional)
18	1	R172060	Control valve 1/4" NPT x tube with nut
19	1	R172036	Silicone lubricant
20	1	R172061	Combination check valve/elbow
21	Optional	R172080	Flow indicator
23	Optional	R172288	1 1/2"-2" Corrosion resistant check valve
24	Optional	R172323	1/4" Corrosion resistant check valve
25	1	R172061B	Standpipe adapter
26	1	R18761	6" Standpipe 3/8" OD x 1/4" ID

*Used on earlier models (not shown)

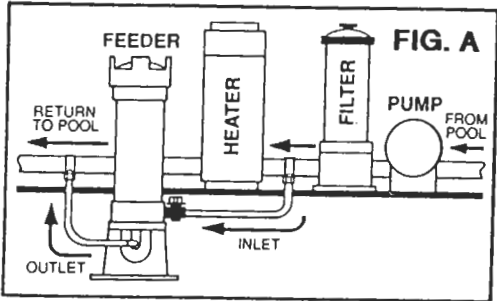

Typical installation with heater

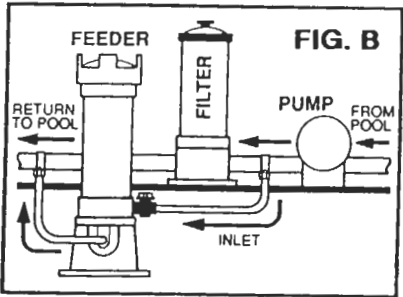

Typical installation without heater



NSF listed for public or residential use in Swimming Pools, Spas or Hot Tubs using Trichlor or Bromine and when used with a flow indicating device such as Rainbow Lifeguard Model #R172080.

U.S. Patent No. 4210624 & 4293425
Canadian Patent No. 1092731

