

Installation Steps

Step 1: Insert the two lower Support Arms into the Mounting Brackets. Next, slide the Lower Support Arm into the Lower Coupler.

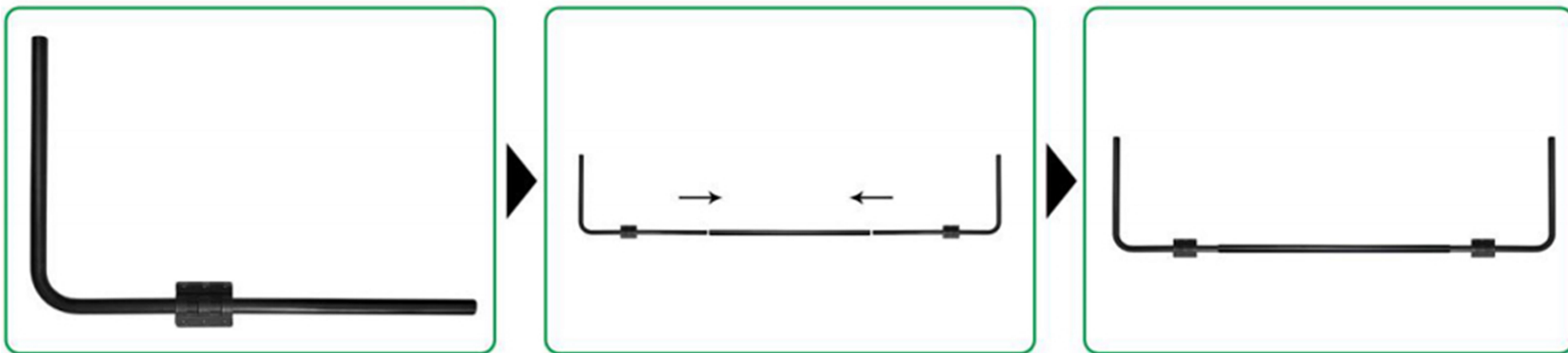

Step 2: Using the Mounting screws to attach the Mounting Brackets to the back side of the spa.



Step 3: Insert the upper Support Arms into the upper Center Coupler Piece. Then join the upper Support Arms Section to the lower Support Arm Section sliding the Support Arms into the side Coupler Piece. When joining the upper Support Arms to the lower Support Arm slip the black nylon Strap over the side Coupler Piece.



Step 4:

①②⑤ : Using the self tapping screws, fasten all Support Arms and Coupler Pieces together.

③④ : Using the Mounting screws attach the Black Nylon Stop Strap to the spa. Next, position the opposite end of the Black Nylon Stop Strap on the Coupler Piece so that it is in a horizontal level position. Using a self tapping screw, and screw strap into place

