



# INSTALLATION INSTRUCTIONS

## 2½" POLY STORM GUNITE JET

### (P/N 210-3710)

#### INSTALLATION PROCEDURES AND PRESSURE TESTING

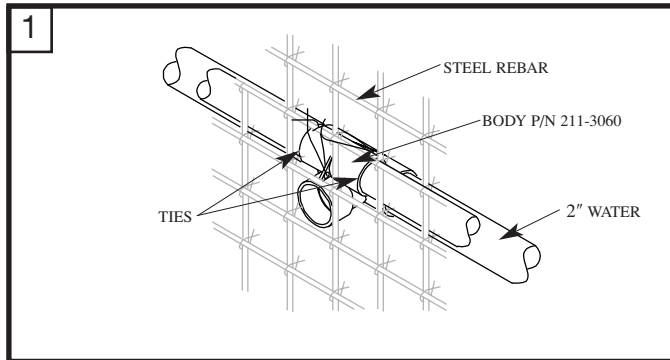

Hang Gunite Poly jet Body with ties through preset holes onto steel rebar.

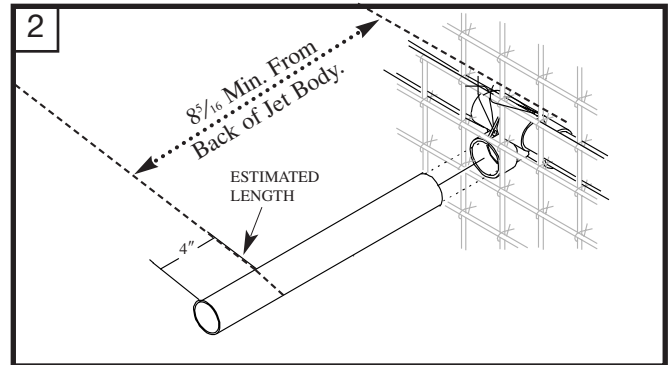

Estimate needed length of 2½" pvc pipe by thickness of wall. Cut 2½" pvc pipe at least 4" longer than estimated. Then glue 2½" pvc pie to Body.

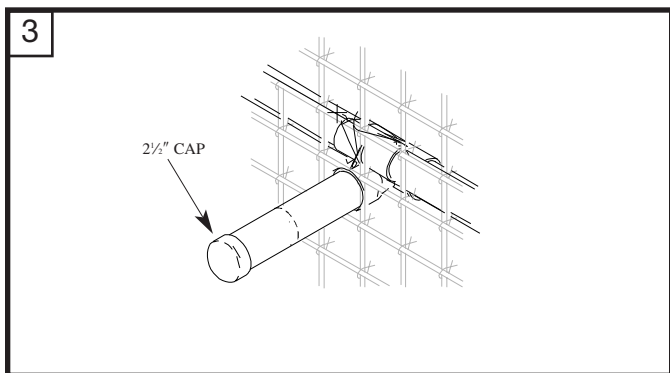

Glue 2½" cap onto end of pipe for pressure test before guniting.

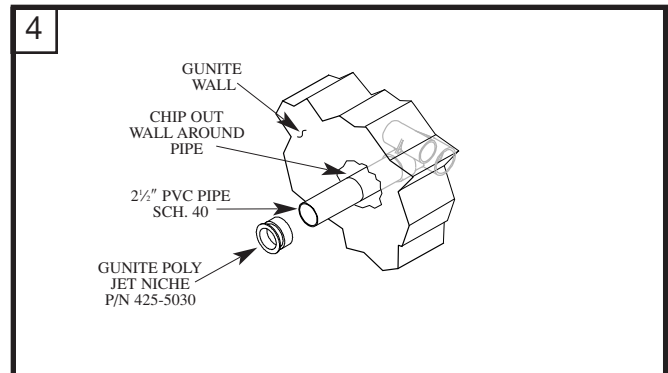

After pool guniting chip out around pipe. Before plastering cut the 2½" pvc pipe inside the wall and glue on the Gunite Poly Jet Plaster Niche P/N 425-5030 (not included). Cover niche with tape then plaster over niche.

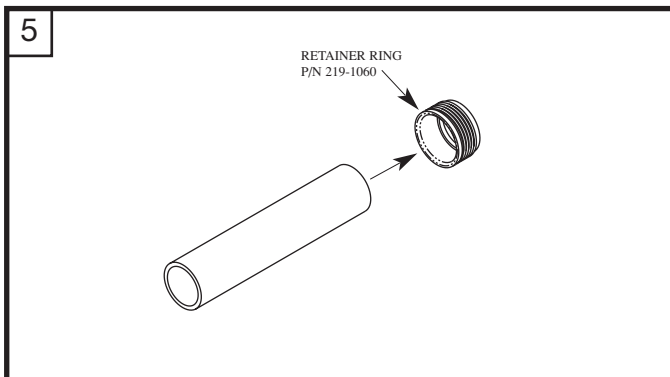

Take 1" pvc pipe, same length as the 2½" pipe and glue the retainer ring to it.

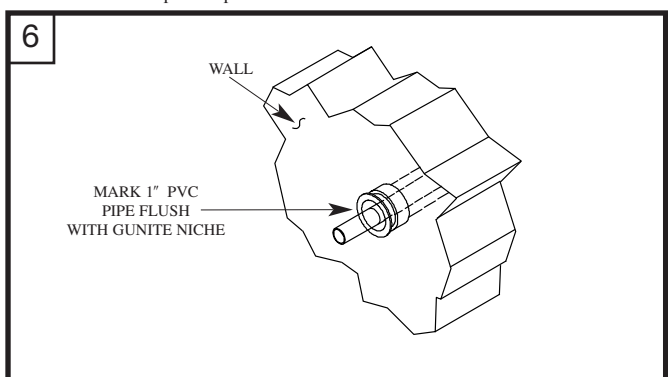

Insert 1" pvc pipe through the niche and up to the gunite poly jet body and thread in until it bottoms out. Make a mark on the 1" pvc pipe flush with the gunite niche.

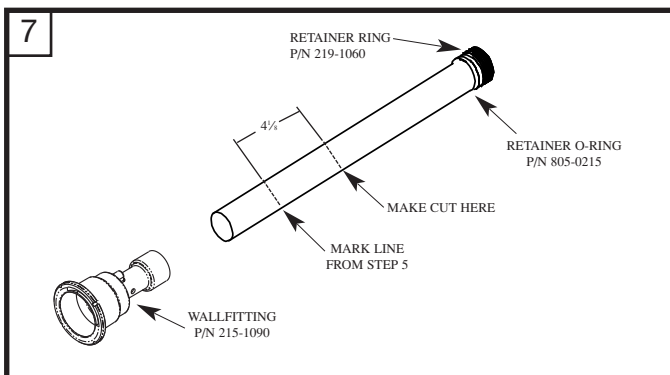

Unscrew 1" pvc pipe from body and cut 4" inward from a mark towards retainer ring, then glue wallfitting to 1" pvc pipe.

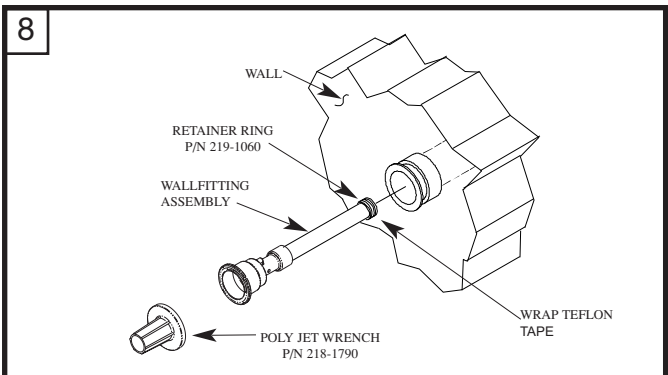

Wrap Teflon tape on retainer ring if necessary and thread the 1" PVC pipe back into body with poly jet wrench, making sure of a snug fit.



# 

#### 

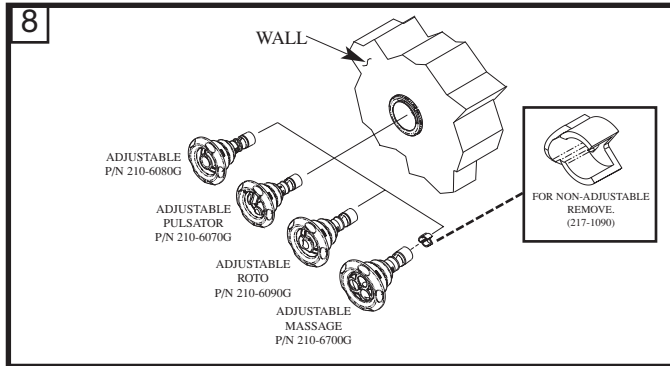

Always use at least one non-adjustable internal per spa to prevent deadheading pump.

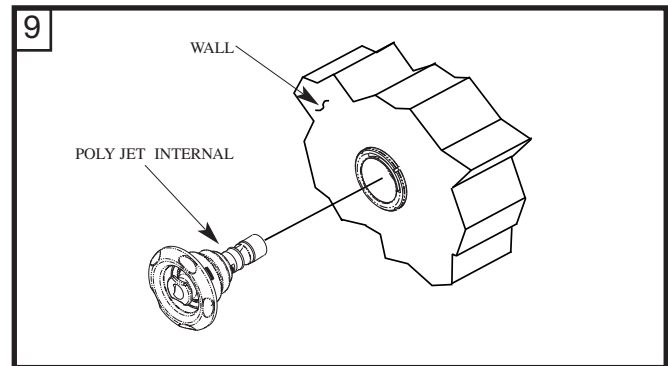

Align tab behind escutcheon face with slot on wallfitting. Location of slot and tab are shown below. Push poly internal into wallfitting until it snaps into place. To adjust water flow turn clock-wise to reduce water flow. To increase water flow turn counter-clockwise until it stops turning. To remove continue turning counter-clock wise past stopping point, you will hear a snap to confirm release of poly internal.

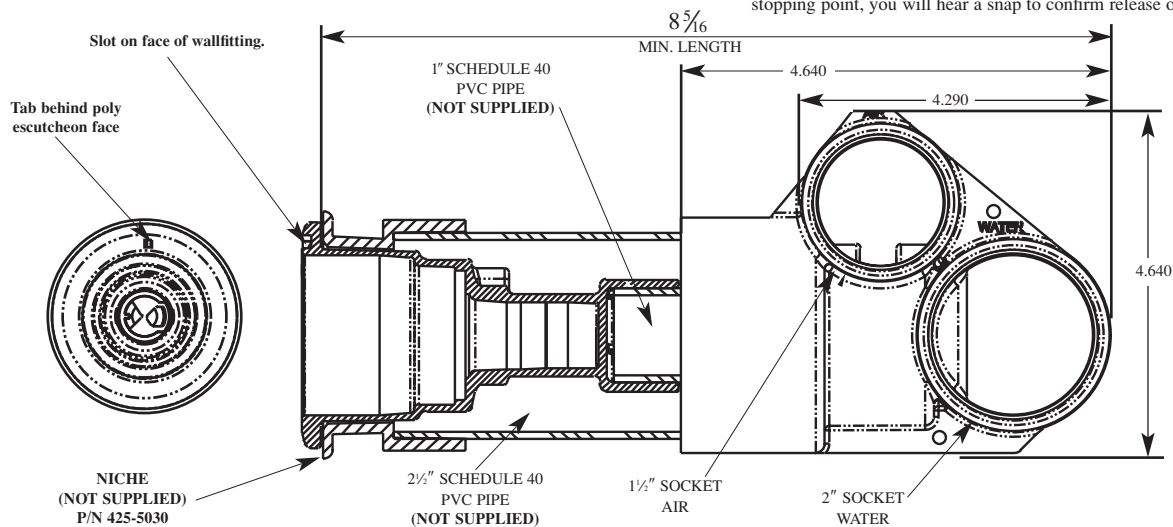

#### 

Always use at least one Non-Adjustable internal per spa to prevent deadheading pump.

#### 

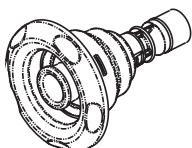

LARGE VOLUME  
INTERNAL  
P/N 212-8047G  
WHITE  
12 GPM

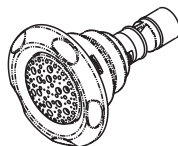

GALAXY INTERNAL  
P/N 212-8190G  
WHITE  
10 GPM

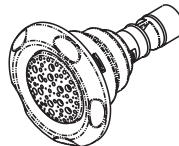

GALAXY MASSAGE  
INTERNAL  
P/N 212-8530G  
WHITE  
10 GPM

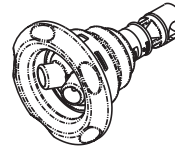

POWER STORM II  
INTERNAL  
P/N 212-8250G  
WHITE  
10 GPM

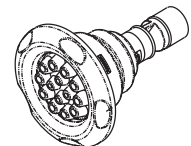

MULTI MASSAGE  
INTERNAL  
P/N 212-8270G  
WHITE  
10 GPM

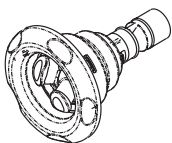

TWIN ROTO  
INTERNAL  
P/N 212-8120G  
10 GPM

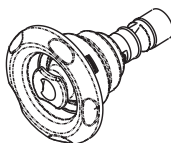

ROTO INTERNAL  
P/N 212-8010G  
WHITE  
10 GPM

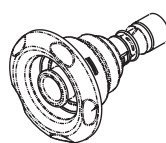

DIRECTIONAL  
INTERNAL  
P/N 212-8050G  
WHITE  
10 GPM

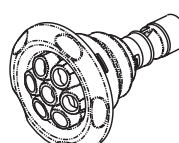

MASSAGE INTERNAL  
(7 NOZZLE)  
P/N 212-8030G WHITE  
10 GPM

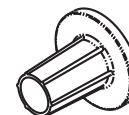

WRENCH  
P/N 218-1790



HANDHELD JET  
P/N 210-3250  
10 GPM